



QUIETLY SUPREME



Introducing the V Platinum V2, featuring an ultra-quiet Mobius fan, 80 Plus Platinum efficiency, optimized thermal performance, dual 40 series GPU support, and ATX 3.1 support with a durable 12V-2x6 cable. Each of these features makes it the ultimate in silent, powerful performance.

The V Platinum V2 also includes a protective conformal coating, a zero-RPM fan mode, fully modular cabling, high-quality Japanese capacitors, and a 12-year warranty, making it one of our most feature-packed PSUs to date.

V Platinum 1600 V2

Ultra-quiet Mobius fan: An ultra-quiet Mobius fan featuring high-performance oil reflow and an innovative ring blade design.

80 Plus Platinum efficiency certification: This unit is certified to achieve more than 92% efficiency at typical loads.

Optimized thermal performance: Anodic-coated heat sinks keep average component temperatures lower than a traditional heat sink for enhanced durability and a prolonged life span.

ATX 3.1 support & a durable 12V-2x6 cable: Includes ATX 3.1 support and a 90-degree 12+4pin (12V-2x6) PCIe 5.1 cable featuring lower temperatures, enhanced durability, and improved safety.

Dual 40 series GPU support: Two 12V-2x6 connectors for dual 40 series GPU support.

Protective coating: A conformal coating provides protection against dust, moisture, and insects.

Interleaved PFC design: An interleaved PFC decreases power loss by minimizing the current and reducing interference.

Smart thermal control mode: Fan speed is automatically adjusted according to the PSU's operating temperature.

Silent fan performance with a zero-RPM mode: This unit defaults to zero fan spin, providing silent fan performance.

Fully modular cabling: Efficiently reduces clutter, increases airflow, and improves overall efficiency and thermal performance.

High-quality Japanese capacitors: Large, high-quality Japanese capacitors feature reduced ripple noise and enhanced reliability.

12-year warranty: This unit comes with a standard limited manufacturing warranty of 12 years from the date of purchase.



FEATURE HIGHLIGHTS



Ring blade design (RBD)

The included Mobius fan features interconnecting blades designed in-house to be reinforced and rigid, for a stable and concentrated airflow.

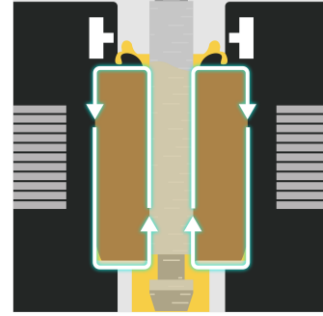

Oil reflow design

Oil reflows behind the Mobius to a sealed bearing that creates constant lubrication and increases the fan's lifespan.



Dual 40 series GPU support

Two 12V-2x6 connectors for dual 40 series GPU support, with 600W per connector for a total of 1200W.

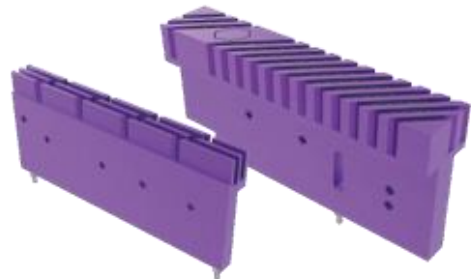

Optimized thermal performance

Anodic-coated heat sinks keep average component temperatures lower.

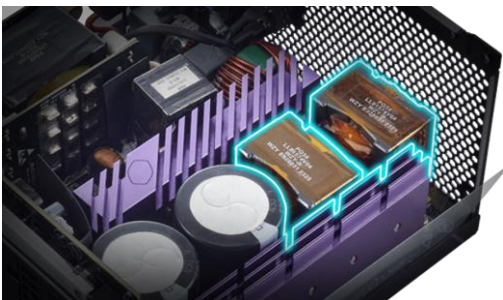

Interleaved PFC design

An interleaved PFC decreases power loss by minimizing the current and reducing interference.



A durable 12V-2x6 cable

An advanced thermal structure and flexible cable provide improved safety.

SPECIFICATIONS

Product Name	V Platinum 1600 V2				
Item Code	MPZ-G002-AFAP				
ATX Version	ATX 12V Ver. 3.1				
PFC	Active PFC				
Input Voltage	100 - 240V				
Input Current	16 - 8A				
Input Frequency	50 - 60Hz				
Dimensions (L x W x H)	160 x 150 x 86mm				
Fan Size	135 mm				
Fan Bearing	LDB (Mobius FAN)				
Fan Speed	2400±10% rpm				
Efficiency	≥ 92% @ Typical Load				
80 PLUS Rating	80 PLUS Platinum				
ErP 2014 Lot 3	Yes				
Operating Temperature	0 ~ 50°C				
Power Good Signal	100 - 150ms				
Hold Up Time	≥ 16ms				
MTBF	>100,000 hours				
Protections	OPP / OVP / OTP / OCP/ SCP / UVP / Surge & Inrush Protection				
Regulatory	cTUVus, TUV, CE, FCC, BSMI, CCC, EAC, RCM, UKCA, RoHS2.0 / BIS, KC (based on region's request.)				
Connectors	ATX 24 Pin	x1 = 1x (650mm)			
	EPS 4+4 Pin	x1 = 1x (650mm)			
	EPS 8 Pin	x1 = 1x (650mm)			
	SATA	x16 = 4x (500+120+120+120mm)			
	Peripheral 4 Pin	x4 = 1x (500+120+120+120mm)			
	PCI-e 6+2 Pin	x5 = 5x (550mm)			
	12V-2x6	x2 = 2x (650mm)			
	AC INPUT	100-240V~ 16 - 8A 50 - 60Hz			
DC OUTPUT	+3.3V	+5V	+12V	-12V	+5Vstb
	20A	20A	133.3A	108.3A	0.3A 3A
TOTAL POWER	120W		1599.6W	1299.6W	3.6W 15W
			For 1600W	For 1300W	
1600W For 115V-240V , 1300W For 100V-115V					

PACKING INFORMATION

Cable Type	EAN	UPC
MPZ-G002-AFAP-BUS	4719512140949	884102113260
MPZ-G002-AFAP-BUK	4719512140956	884102113277
MPZ-G002-AFAP-BEU	4719512140963	884102113284
MPZ-G002-AFAP-BST	4719512140970	884102113291
MPZ-G002-AFAP-BAU	4719512140987	884102113307
MPZ-G002-AFAP-BBR	4719512140994	884102113314
MPZ-G002-AFAP-BKR	4719512141007	884102113321
MPZ-G002-AFAP-BTW	4719512141014	884102113338
MPZ-G002-AFAP-BJP	4719512141021	884102113345
MPZ-G002-AFAP-BIN	4719512141038	884102113352
MPZ-G002-AFAP-BWO	4719512141045	884102113369

Net Weight	3.55 kg
Gross Weight	4.40 kg
Package Dimensions	320 x 195 x 125mm
Carton Dimensions	520 x 335 x 231mm
Unit / Carton	4pcs
Carton / Pallet	24pcs

- All images and descriptions are solely for example purposes.
- Specifications, features, and prices are subject to change without notice.
- Specifications, appearances, and features may vary by model and region. Please refer to official specification pages for full details.
- Unless otherwise stated, all performance claims are based on theoretical performance. Actual figures may vary in real-world situations.
- Any configuration other than original product configuration is not performance guaranteed.